

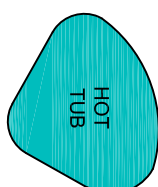

TRACY FOGTMANN
PERSONAL REAL ESTATE CORPORATION



1476 JACKSON DR.
2613 SQ. FT.



LOWER FLOOR

966 SQ. FT.

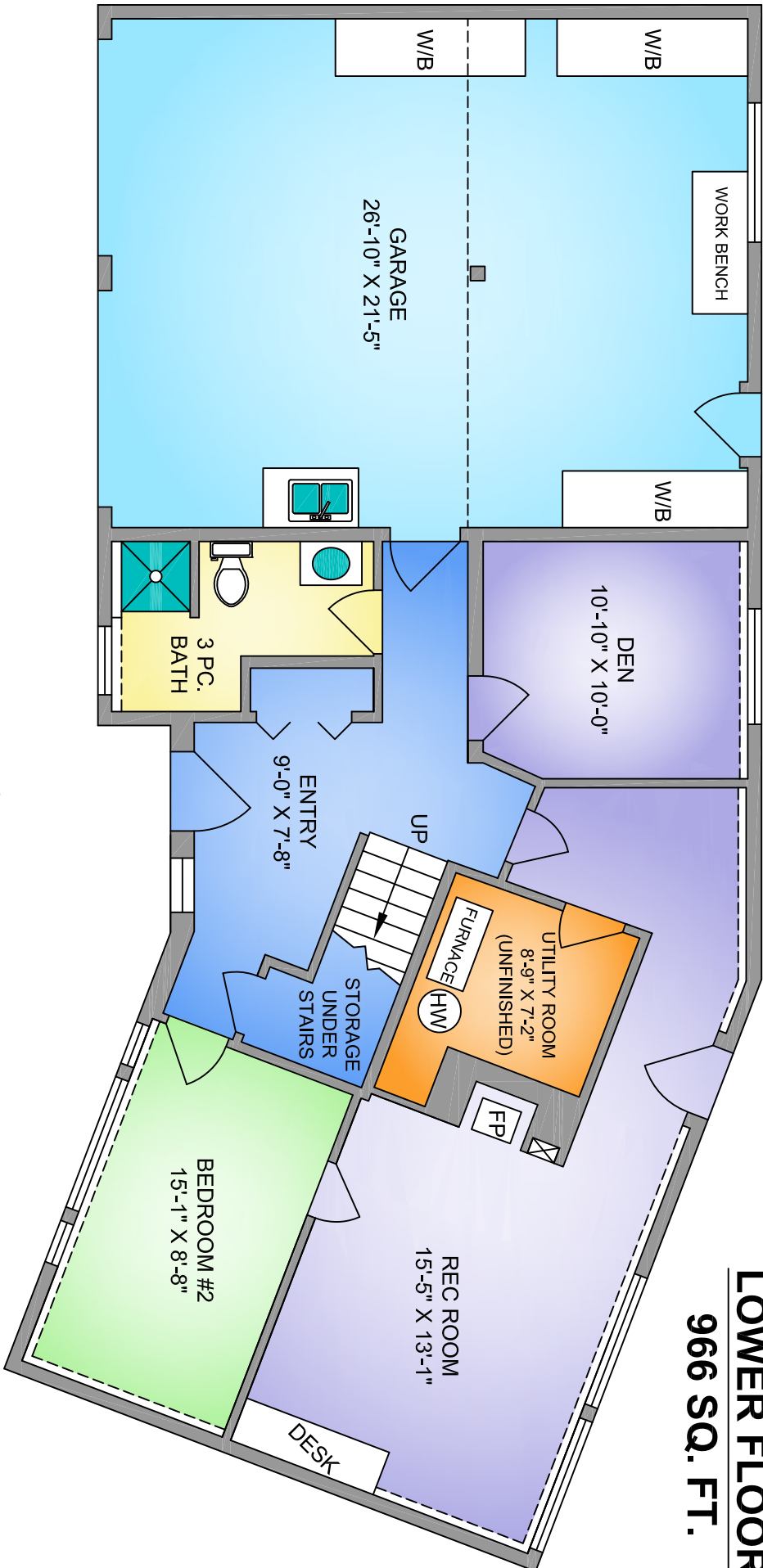

1476 JACKSON DR

APRIL 01, 2019

Prepared by PROPER MEASURE NORTH ISLAND for the exclusive use of TRACY FOGTMANN

Plans may not be 100% accurate. Buyer must verify any critical measurement.

Private resale or modification of floor plans to a third party by any individual or entity other than Proper Measure North Island is strictly prohibited.

| FLOOR | AREA (SQ. FT.) | | | |
|-------|----------------|------------|--------|--------------|
| | FINISHED | UNFINISHED | GARAGE | DECK / PATIO |
| MAIN | 1647 | - | 616 | - |
| LOWER | 966 | 65 | - | 452 |
| TOTAL | 2613 | 65 | 616 | 452 |

NORTH

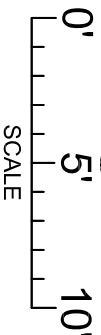

PROPER MEASURE
FROM PRECISION TO PERFECTION



250-465-1487
Proper Measure North Island
NorthIsland@Propermeasure.com